

Instructions for Installing FiberChekPRO and Drivers on Windows8

- 1) From the Start Screen in Windows 8 bring up the Settings bar, either with the mouse or use the key Ctrl-I

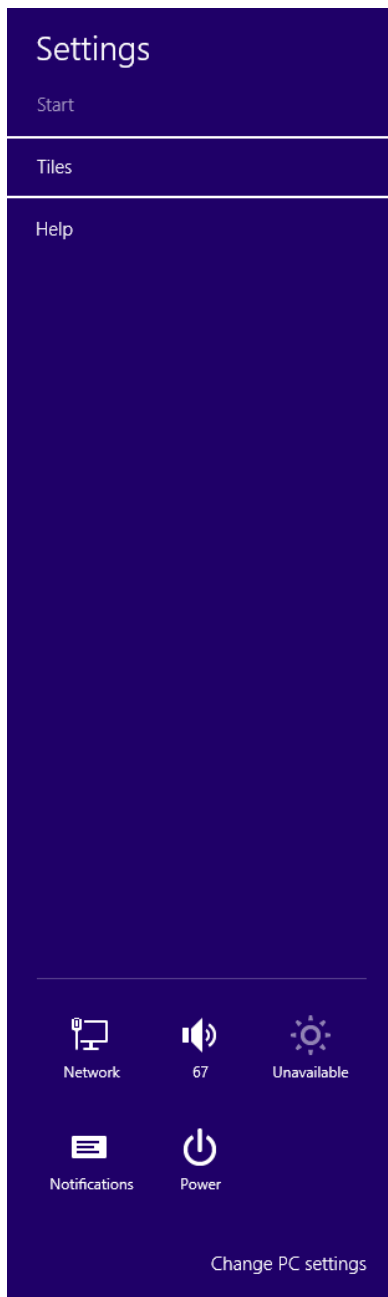

- 2) At the bottom of the settings bar click “Change PC Settings”
- 3) From the PC Settings Screen, select “General”, then scroll down to the bottom of the General settings and select “Advanced Startup” and click on the “Restart now” button.

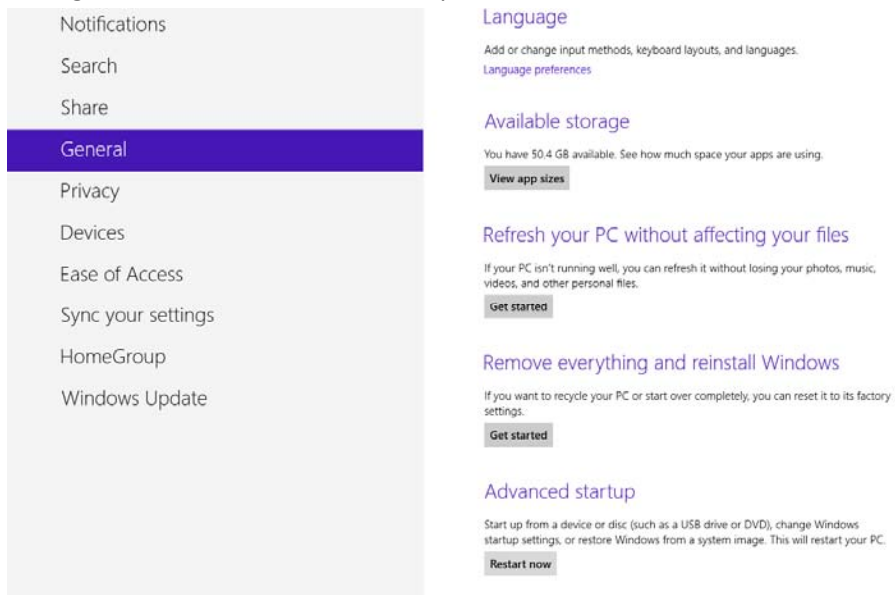

- 4) Select the Troubleshoot option

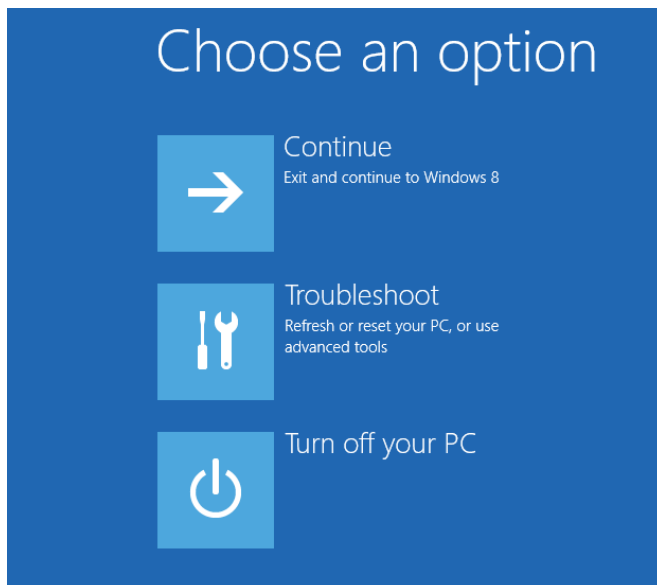

5) On the Troubleshoot screen Select Advanced options



6) On the Advanced options screen, select Startup Settings

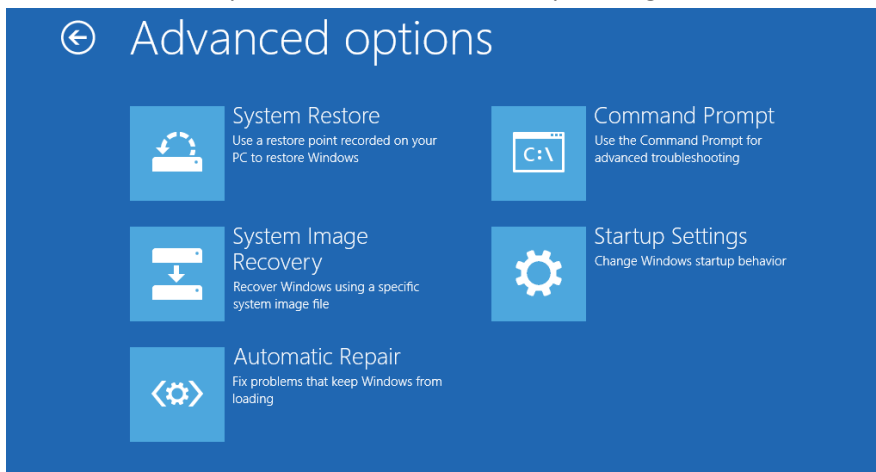

7) On the Startup Settings screen, Click the Restart Button.

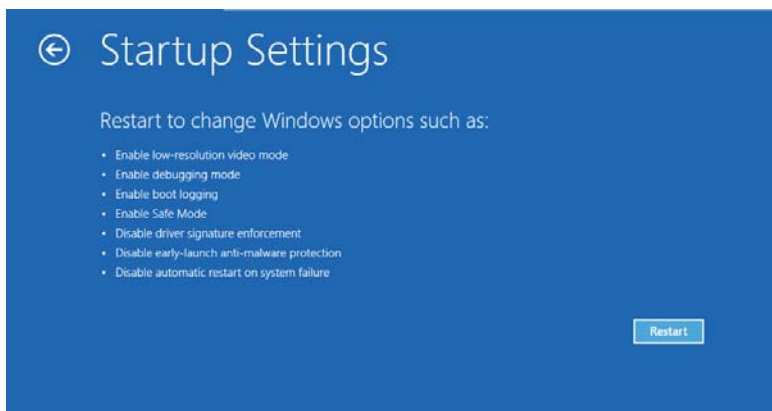

8) Once the machine restarts, the following screen will appear

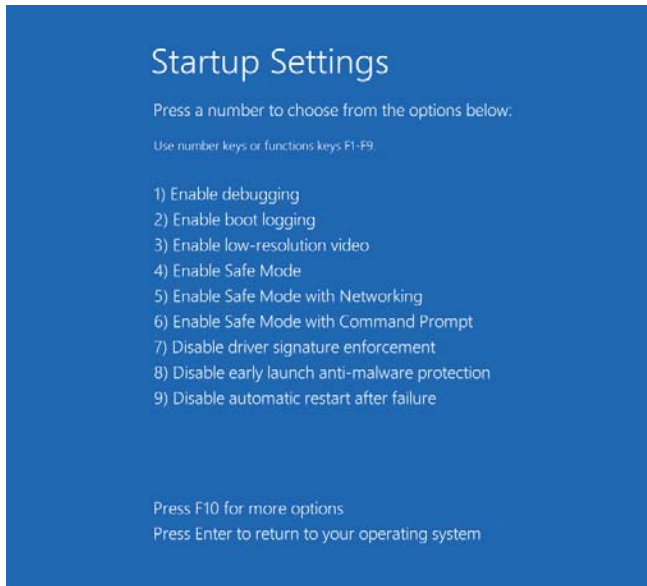

- 9) Select option 7 – Disable driver signature enforcement, by pressing the 7 or F7 key on the keyboard. Windows 8 will now restart in a mode where unsigned drivers are permitted to be installed.
- 10) After Windows 8 restarts the user can install FiberChekPRO software, the installer will install the necessary drivers.

NOTE: This is a temporary mode; once the machine is restarted again unsigned drivers will not be able to be installed until the above steps are repeated.

This will allow the FiberChekPRO installer to install drivers for the supported devices. Supported devices for Windows 8 are

64 and 32 Bit

Microscope	64-Bit Support	32 Bit Support
P5000i	X	X
OLP-82	X	X
HD4i	X	X
P5000 – Rev A		X
P5000 – Rev B	X	X
P5000 – Rev B2	X	X
FVA – Rev B	X	X
FVA – Rev B2	X	X
FVD – Rev A		X
FVD – Rev B	X	X
FVD – Rev B2	X	X
P5000 – Analog Probe		X