

W1 Shorting Plug | Order Code 58003 | Legacy Part Number 55-1000-A1

Part of the PSDAF-CN235AC. The Shorting Plug connects to the aircraft wiring at the tank wall. Provides shorts to all megger measurement paths to test for faults in the aircraft wiring between the Signal Conditioner / Junction Box and the tank wall.

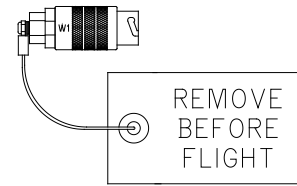

EADS CASA CN-235 and C-295 DC Capacitive Fuel System

PSDAF-CN235DC | Order Code 58004 | Legacy Part Number 55-1000-B0

The PSDAF-CN235DC interfaces routes all needed signals to and from the PSD90-1C to measure the DC Capacitance of tank units in the left/right main and AUX tanks, measure the insulation resistance of the tank probes and aircraft wiring, and simulate capacitance values for the operation and calibration of the indicators.

Note: For use with DC capacitive fuel systems only



W1 Cable | Order Code 86743 | Legacy Part Number 55-1000-B1

Part of the PSDAF-CN235DC Interface. Used to mate the J1 connector of the PSDAF-CN235DC to the J2 connector (left side tanks) of the fuel control unit.



W2 Cable | Order Code 86742 | Legacy Part Number 55-1000-B2

Part of the PSDAF-CN235DC Interface. Used to mate the P1 connector of the PSDAF-CN235DC to the aircraft wiring harness removed from the J2 connector (left side tanks) of the fuel control unit.

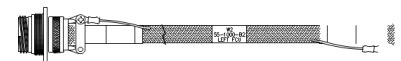

W3 Shorting Plug | Order Code 86744 | Legacy Part Number 55-1000-B3

Part of the PSDAF-CN235DC Interface. Used to mate the P1 connector of the PSDAF-CN235DC to the aircraft wiring harness removed from the J2 connector (left side tanks) of the fuel control unit.

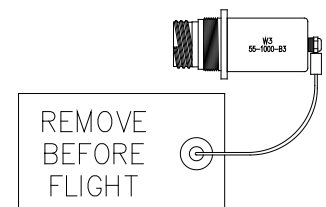

W4 Probe Interface | Order Code 86745 | Legacy Part Number 55-1000-B4

Part of the PSDAF-CN235DC Interface. Used to mate the P1 connector of the PSDAF-CN235DC to the aircraft wiring harness removed from the J2 connector (left side tanks) of the fuel control unit.

